

## M43640

BRIDA 6.000 LIBRAS CODO 45° ISO /SAE CÓDIGO 62 - SAE J516 / ISO 12151-3

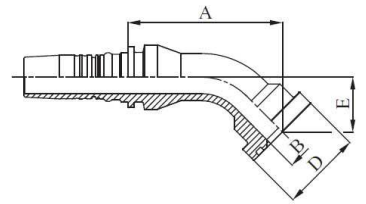

REF.	DIÁMETROS DE MANGUERA			ROSCAS	DIMENSIONES			
	DN	inch	Size		T	B	A	D
M43640-10-12	16	5/8"	- 10	3/4"	16,0	71,0	41,4	31,0
M43640-10-16	16	5/8"	- 10	1"	20,0	83,5	47,7	32,5
M43640-12-12	19	3/4"	- 12	3/4"	16,0	81,0	41,4	28,0
M43640-12-16	19	3/4"	- 12	1"	20,0	85,4	47,7	32,3
M43640-16-12	25	1"	- 16	3/4"	16,0	87,0	41,4	28,0
M43640-16-16	25	1"	- 16	1"	20,0	91,4	47,7	32,3
M43640-16-20	25	1"	- 16	1.1/4"	26,0	93,7	54,2	37,5
M43640-20-16	31	1.1/4"	- 20	1"	20,0	106,5	47,7	36,0
M43640-20-20	31	1.1/4"	- 20	1.1/4"	26,0	108,0	54,2	37,5
M43640-20-24	31	1.1/4"	- 20	1.1/2"	32,0	115,0	63,7	45,0
M43640-24-20	38	1.1/2"	- 24	1.1/4"	26,0	124,5	54,2	43,0
M43640-24-24	38	1.1/2"	- 24	1.1/2"	32,0	124,3	63,7	44,0
M43640-24-32	38	1.1/2"	- 24	2"	42,0	135,6	79,6	55,4
M43640-32-32	51	2"	- 32	2"	42,0	154,0	79,6	60,5

## M43910

BRIDA RECTA SUPERCAT

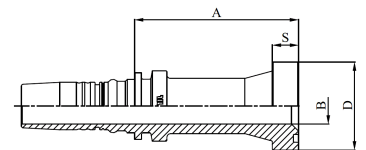

REF.	DIÁMETROS DE MANGUERA			ROSCAS	DIMENSIONES			
	DN	inch	Size		T	B	A	D
M43910-12-12	19	3/4"	- 12	3/4"	16,0	77,0	41,5	14,3
M43910-12-16	19	3/4"	- 12	1"	20,0	88,5	47,7	14,3
M43910-16-16	25	1"	- 16	1"	20,0	89,5	47,7	14,3
M43910-16-20	25	1"	- 16	1.1/4"	26,0	93,5	54,0	14,3
M43910-20-20	31	1.1/4"	- 20	1.1/4"	26,0	95,2	54,0	14,3
M43910-20-24	31	1.1/4"	- 20	1.1/2"	32,0	98,5	63,6	14,3
M43910-24-24	38	1.1/2"	- 24	1.1/2"	32,0	99,2	63,6	14,3
M43910-24-32	38	1.1/2"	- 24	2"	42,0	115,0	79,3	14,3
M43910-32-24	51	2"	- 32	1.1/2"	32,0	119,0	63,6	14,3
M43910-32-32	51	2"	- 32	2"	42,0	114,0	79,3	14,3